

⚠️ WARNING

To reduce risk of serious injury from collapse, crush, laceration or pinch hazards:

- Read & follow safety information & instructions before use.
- Never allow a child to fold/unfold table.
- Never allow a child under 3 years of age to use this table. Use only with adult supervision
- Always make sure table is locked in open position prior to use.
- Keep hands/fingers away from pivot points and latches.
- Never allow a child to sit/stand on table top.
- Maximum load capacity: 25 pounds
- Never use table outdoors.

TO OPEN TABLE

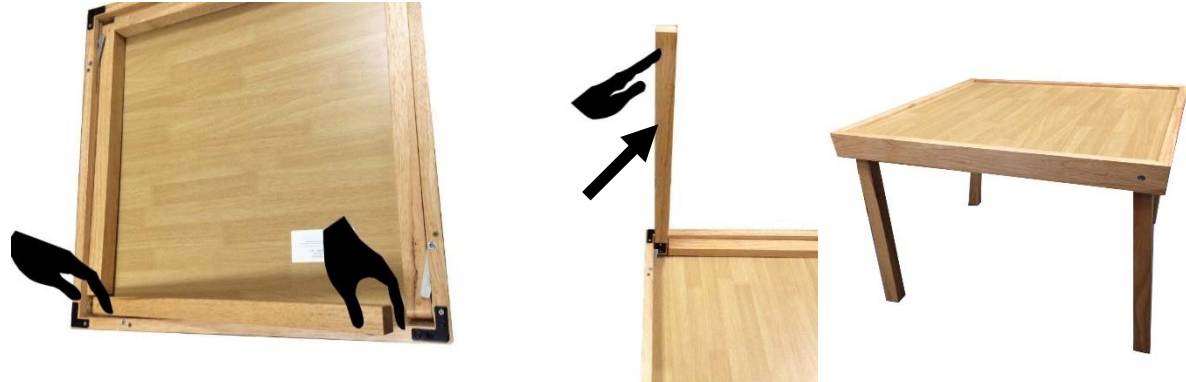

Lay table face down on a soft flat surface. To open leg, depress lever lock into frame and pull up on leg at the same time. Push leg up until lever lock releases and locks leg in place. You will hear a snap or click when leg locks in place – you may have to push on leg slightly to lock in place. Repeat same steps for remaining legs.

TO FOLD/CLOSE TABLE



To fold table legs, depress lever lock and fold leg inward until leg is flat and lever lock pops up. You will hear a snap or click when leg locks in place. Repeat this for the remaining legs.

MECO Corporation – 1500
Industrial Road – Greeneville,
Tennessee 37745

Customer Service: 800-251-7558
www.meco.net